

K588

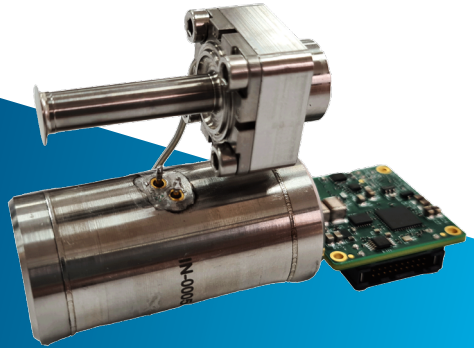

- Designed to Maximum SWaP-C Advantages
- For HOT Detectors at 120-180K
- Highly Efficient Cooler – 2.1 Wdc Typ. @150K & 180mW & 23°C
- Dual Opposed Linear Compressor with Compact Size - D26mm x L52mm
- Compact Cold Head with Generic Cold Finger - 46mm
- Not Detectable from 10m with very low induced force signature
- Ideal for Hand Held and Other Miniature Applications

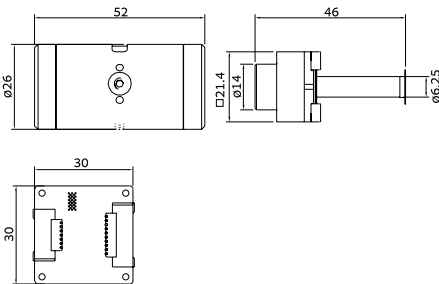

Dimensions in mm

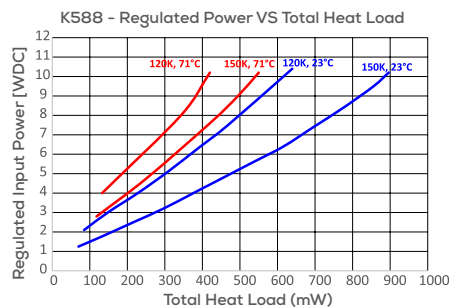
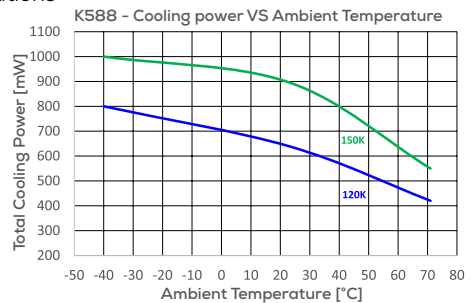

SPECIFICATIONS

• Total cooling power: 550mW@150K@71°C 420mW@120K@71°C	• Cold tip temperature range: 120K-180K	• Meets environmental conditions per MIL-STD-810
• MTTF: >30,000hr (D.Goal) @Basic profile	• Product maturity: under development	• Acoustic noise: Non detectable from 10m according to MIL-STD-1474E
• Steady state input power: (180mW@150K@23°C): 2.1 Wdc typ.	• Cooler weight: 190 gr	• Service life: 15 years
• Maximum input power: 12 Wdc typ.	• Controller weight: 10gr	• Standard warranty*: 5,000hr/2 years
• Cool down time: (180J@150K@23°C): 2min. typ.	• Input voltage: 5.5-16Vdc	• Option to propose extended warranty
	• Ambient temperature range: - Operational: -40°C...+71°C - Non-Operational: -55°C...+85°C	
	• Temperature stability: ±0.1K	